



PGCPS . **ENGAGE . DESIGN . BUILD . COMMUNICATE** . PGCPS



BRENT ELEMENTARY SCHOOL

TOWN HALL MEETING | OCTOBER 9, 2024



SERVICIOS DE INTERPRETACIÓN

INTERPRETING SERVICES

La interpretación simultánea
está disponible en español.
*Simultaneous interpretation is
available in Spanish.*

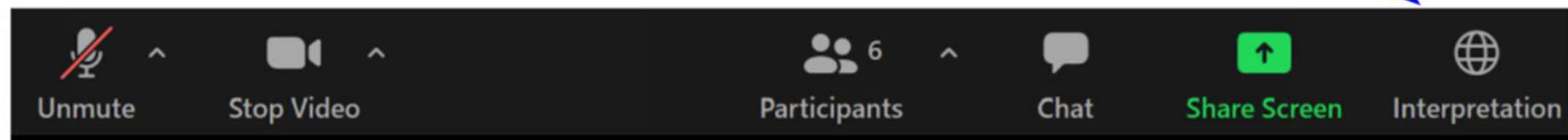

SERVICIOS DE INTERPRETACIÓN

INTERPRETING SERVICES

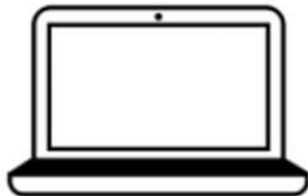

On a computer-- At the bottom of the screen will be an interpretation globe. Click that globe and then select *Spanish*.

En una computadora-- En la parte baja de la pantalla habrá un globo de interpretación. Haga clic en ese globo y seleccione "Spanish."



On a mobile device-- At the bottom of the screen, tap the ellipses icon on the bottom right (...).

- Tap *Language Interpretation*.
- Tap *Spanish*.

En un dispositivo móvil-- En la parte baja de la pantalla, toca el icono de elipses en la parte baja derecha (...).

- Toque *Language Interpretation*.
- Toque *Spanish*.

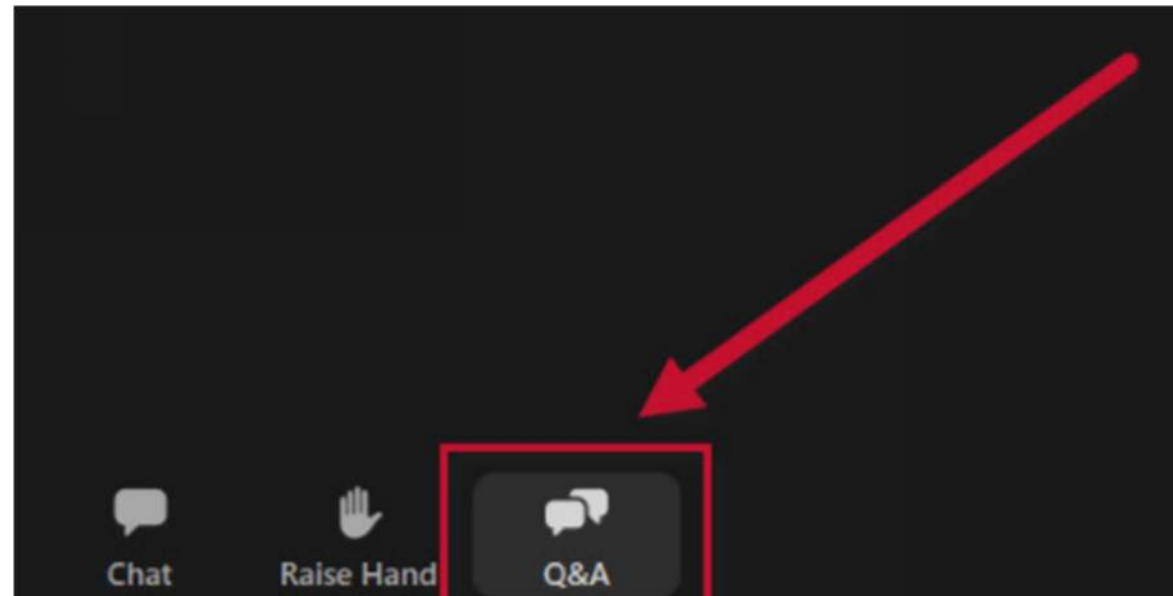

We value your input.

- Please type your questions/comments in the Q&A area of Zoom.
- Questions and answers from this town hall will be posted on pgcpsblueprintschools.com.



Our Commitment

PGCPS is committed to moving swiftly to deliver safe, state-of-the-art, and sustainable learning environments for our students, teachers, and communities.



Agenda

- Team Introduction
- Design Updates
- Construction Schedule
- Questions
- Contacts

Team Introductions



Jeff Barr
PLENARY
Registered Representative

Hafeez Habib
PLENARY
Equity Members' Lead Project Manager

Brett Sullivan
PLENARY
Associate

Adam Dunn
PLENARY
Assistant Project Manager

Jeremy Ebie
PHOENIX
Equity Members' Project Manager

Rob Summers
PHOENIX
Operating Partner

Peter Bullen
ELLISDON CAPITAL
Senior Director



Bill Beschorner
MCN
Construction Process Executive in Charge

Bassem Boustany
MCN
Principal

Yonas Menji
MCN
Lead Construction Manager

Rick Munford
MCN
Preconstruction Director

Rekik Zelleke
MCN
Project Manager



Sean O'Donnell
PERKINS EASTMAN
Design Process Executive In Charge & Lead Architect

Omar Calderon
PERKINS EASTMAN
Design Principal

Jack Chin
PERKINS EASTMAN
Project Manager



Pete Cambell
ELLISDON FS
Director, P3 Pursuits

Brandon Kelley
USF
Vice President

Johnathan Bolden
RSC
President



Sharon Bradley
BSD
Principal

Ivan Zapata
BSD
Director of Civil Engineering

Matthew Cartledge
BSD
Project Manager/ Landscape Architect



Jam Kendrick
TB&A
Project Manager

Updated Site Plan

- Bus drop-off
- Vehicular parking
- Outdoor classroom and play areas

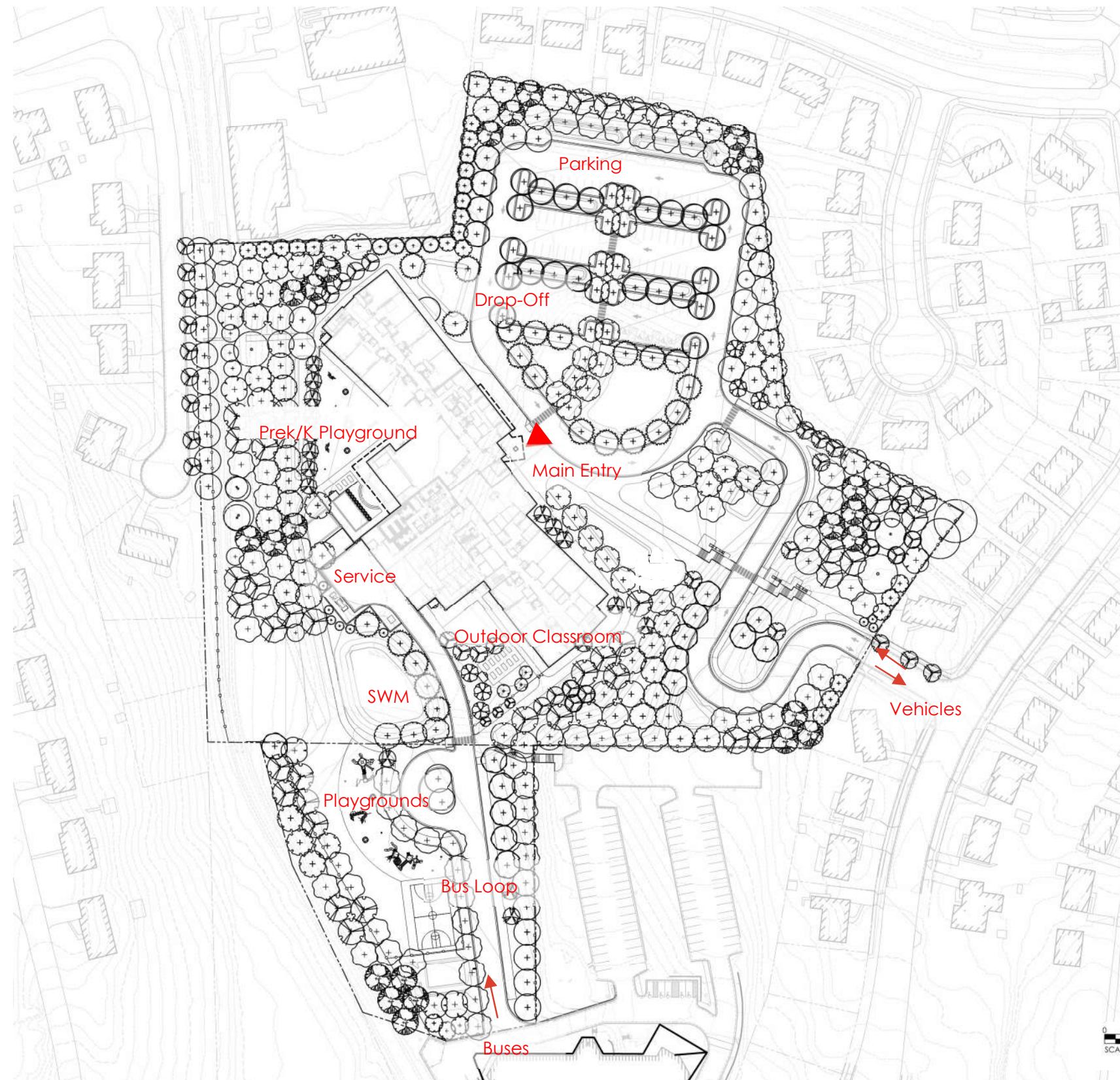

Note: Design is subject to change

Progress Interior Views



Cafeteria



Library

- Final finishes to be coordinated with school.

Heart of the School:

- Library
- Gym
- Dining & Stage (below)



Note: Design is subject to change





Note: Design is subject to change



Progress Interior Views

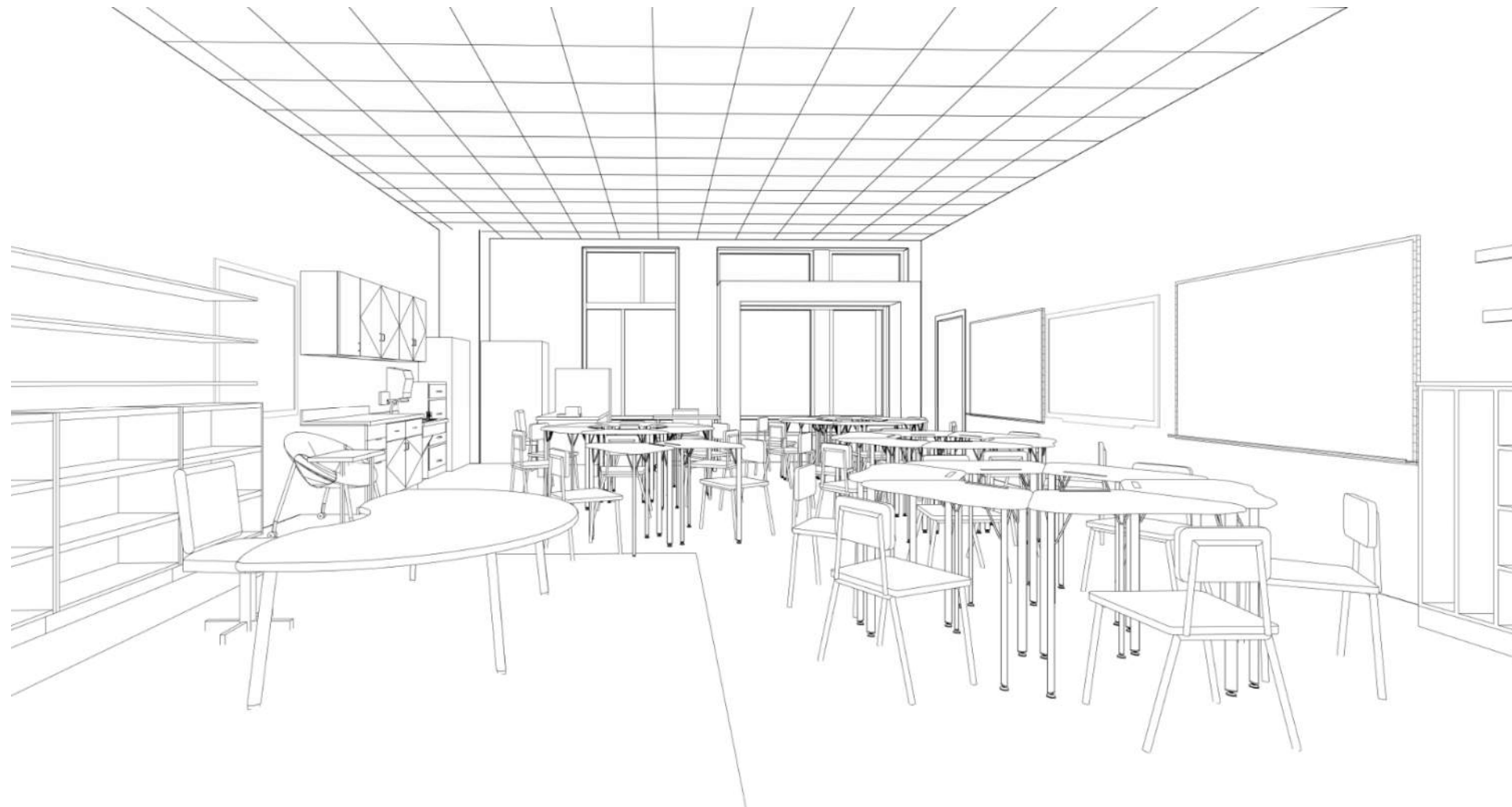

Typical Classroom

- Final finishes to be coordinated with school.

- Music & Art conveniently located in the Heart



DEPARTMENT

ACADEMIC - CORE
ACADEMIC - EXTENDED
ADMINISTRATION
CIRCULATION
MEDIA CENTER
PERF ARTS
PHYS ED
SPEC ED
SUPPORT
VISUAL ARTS

Note: Design is subject to change

Second Level Plan



Progress Interior Views

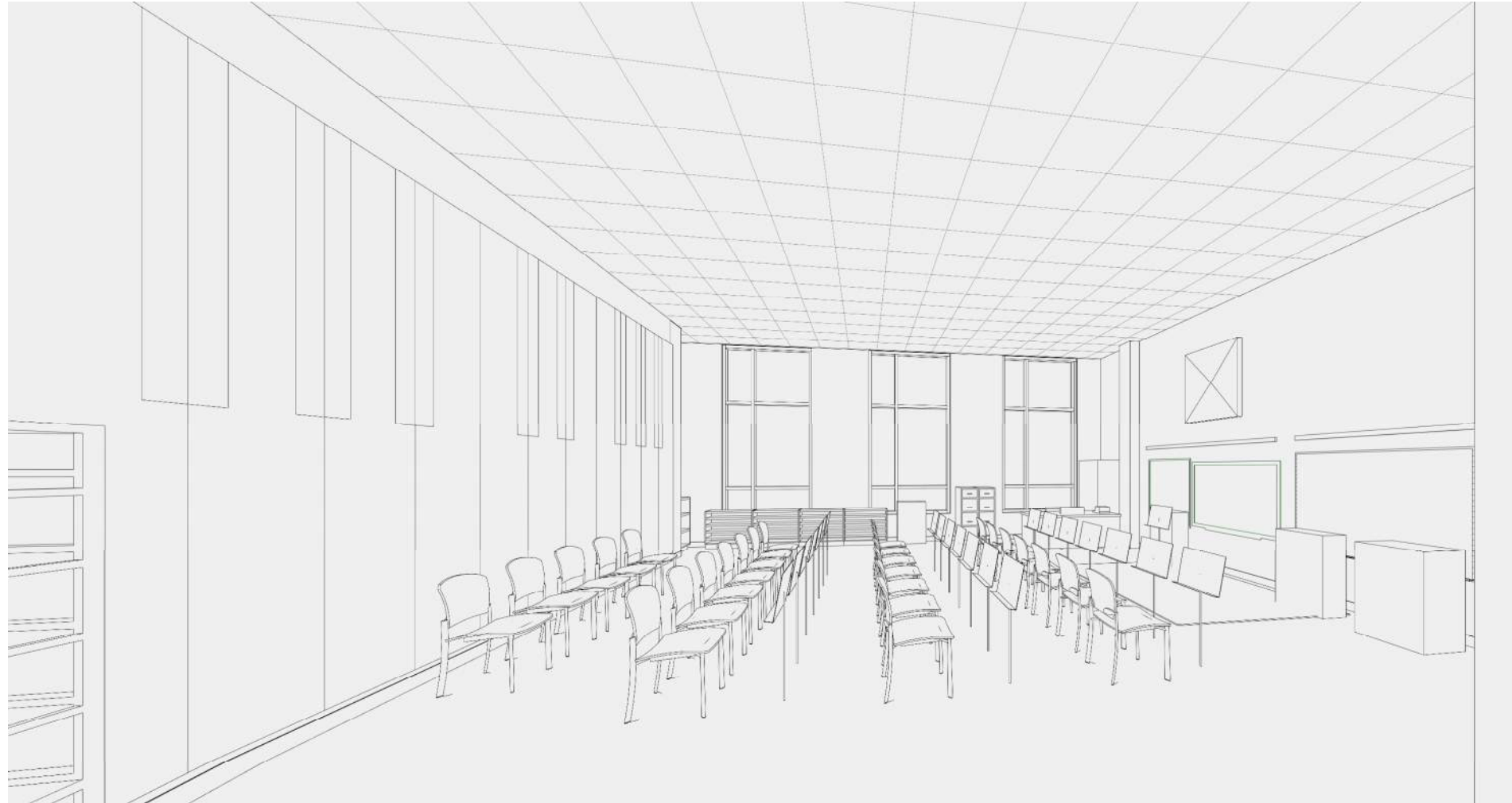

Music Room

- Final finishes to be coordinated with school.

Elevations and Renderings



Note: Design is subject to change

Elevations and Renderings



Note: Design is subject to change

Schedule Overview

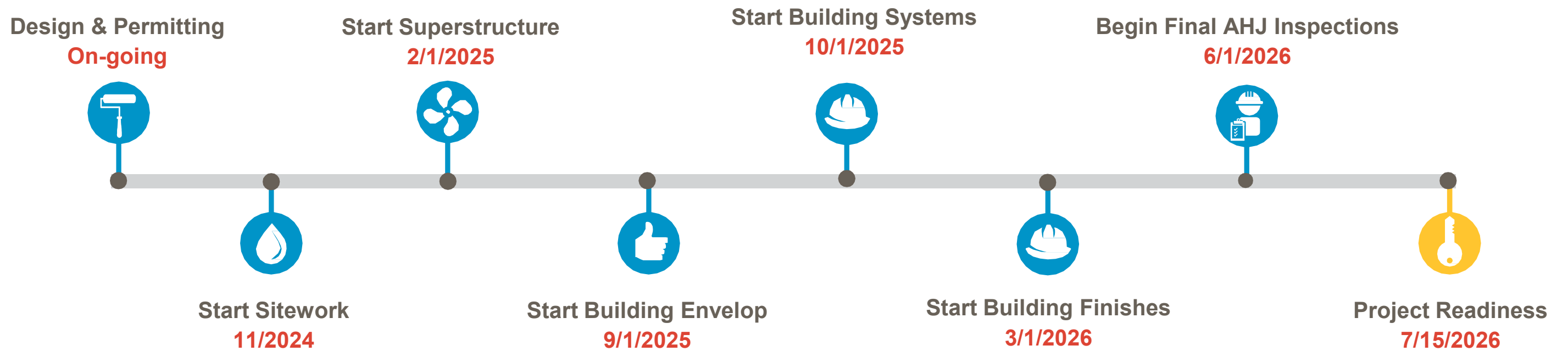

Questions?

For more general information, please contact:



Jam Kendrick

pg_jam.kendrick@pgcps.org

For more construction information, please contact:



Rekik Zelleke

rekik.zelleke@mcnbuild.com