

## E

- D

- C

- B

- A

BLADENSBURG, MD 20710

The map shows the project site in East Riverdale, Baltimore. The site is a shaded brown polygon located between Madison St and 53rd Ave, and between the Baltimore-Washington Parkway and the Annapolis River. Surrounding areas include Rogers Heights to the west and Woodlawn to the east. Key landmarks include the Annapolis River SVP, Taqueria La Placita, and various schools and parks.



Sheet List Table	
SHEET NUMBER	SHEET TITLE
L001	COVER SHEET
L100	CONCEPT PLAN
L120	MATERIALS PLAN ENLARGEMENT - NORTH
L121	MATERIALS PLAN ENLARGEMENT - SOUTH
L220	LAYOUT PLAN ENLARGEMENT - NORTH
L221	LAYOUT PLAN ENLARGEMENT - SOUTH
L230	LAYOUT PLAN ENLARGEMENTS
L300	SOILS PLAN
L400	PLANTING PLAN - CANOPY
L401	PLANTING PLAN ENLARGEMENT - NORTH
L402	PLANTING PLAN ENLARGEMENT - SOUTH
L410	PLANTING SCHEDULE & NOTES
L420	PLANTING DETAILS
L500	PRODUCT INFORMATION
L501	PRODUCT INFORMATION
L502	PRODUCT INFORMATION - PLAY
L510	CONSTRUCTION DETAILS
L511	CONSTRUCTION DETAILS
L512	CONSTRUCTION DETAILS

[illegible]

**KEY PLAN**

ENVIRONMENTAL &amp; GEOTECHNICAL

PROJECT TITLE: \_\_\_\_\_

## BLADENSBURG, MD 20710

PROJECT No: 0100141

DRAWING TITLE:

DRAWING TITLE:

COVER SHEET

---

# 1001

## 2001

95% DESIGN DEVELOPMENT SET

01 NOVEMBER 2024

NOT FOR CONSTRUCTION

5

4

3

2

1



















[illegible]

PROJECT:  
**P3 PRINCE GEORGE'S COUNTY PUBLIC  
SCHOOLS BLUEPRINT SCHOOLS PH 2**

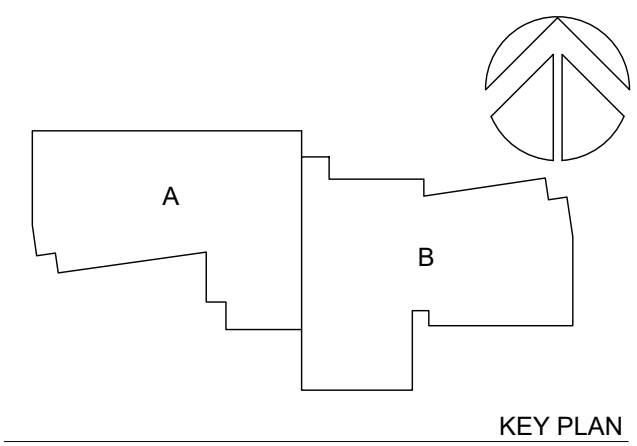

**PERKINS —  
EASTMAN**  
One Thomas Circle NW, Suite 200  
Washington, DC 20005  
T. +1 202 861 1325  
F. +1 202 861 1326

OWNER:  
**PRINCE GEORGE'S COUNTY PUBLIC SCHOOLS**

CLIENT:  
**PROGRESSIVE EDUCATION PARTNERSHIP**

GENERAL CONTRACTOR:  
**MCN BUILD**  
1214 28TH ST NW, Washington, DC 20007

ASSOCIATE ARCHITECT:  
**R. MCGHEE & ASSOCIATES, PLLC**  
2031 Florida Ave. NW, 3rd Floor, DC 20009

CIVIL / SITE:  
**BRADLEY SITE DESIGN**  
1010 Wisconsin Ave. NW, Ste.620, DC 20007

LANDSCAPE:  
**BRADLEY SITE DESIGN**  
1010 Wisconsin Ave. NW, Ste.620, DC 20007

STRUCTURAL:  
**YUN ASSOCIATES**  
1050 Connecticut Ave. NW, Ste.500, DC 20036

MEPFP, LIGHTING & ENERGY MODELING:  
**CMTA INC. CONSULTING ENGINEERS**  
 220 Lexington Green Circle Ste. 600, Lexington, KY 40502

FOOD SERVICE:  
**NYIKOS ASSOCIATES**  
7146 Starmount Way, New Market, MD 21774

**SPECIFICATIONS:**  
**HELLER & METZGER PC**  
1899 Pennsylvania Ave. NW, Ste. 220, DC 20006

**SUSTAINABILITY, WELL, SPECIALIST:**  
**PERKINS EASTMAN ARCHITECTS**  
One Thomas Circle NW, Ste. 200, Washington, DC 20005  
ACQUITTICS:

**POLYSONICS**  
405 Belle Air Lane, Warrenton, Va 20186  
AV, IT & SECURITY:

**CMTA INC. CONSULTING ENGINEERS**  
220 Lexington Green Cir. Ste. 600, Lexington, KY 40501  
CODE CONSULTANT:

ENVIRONMENTAL &amp; GEOTECHNICAL:

TRAFFIC CONSULT:  
**THE TRAFFIC GROUP**  
9900 Franklin Square Drive, Ste. H, Baltimore, MD 21206

PROJECT TITLE: \_\_\_\_\_

TEMPLETON  
ELEMENTARY  
SCHOOL

BLADENSBURG, MD 20710

PROJECT No: 0100141

DRAWING TITLE:  
LAYOUT PLAN  
ENLARGEMENT -  
SOUTH

SCALE: 1" = 20'

**L221**

95% DESIGN DEVELOPMENT SET

01 NOVEMBER 2024



NOT FOR CONSTRUCTION



[illegible]

PROJECT:  
**P3 PRINCE GEORGE'S COUNTY PUBLIC  
SCHOOLS BLUEPRINT SCHOOLS PH 2**

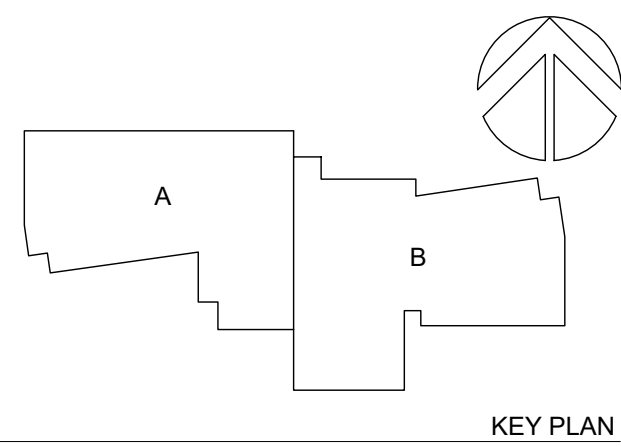

**PERKINS —  
EASTMAN**  
One Thomas Circle NW, Suite 200  
Washington, DC 20005  
T. +1 202 861 1325  
F. +1 202 861 1326

OWNER:  
**PRINCE GEORGE'S COUNTY PUBLIC SCHOOLS**

CLIENT:  
**PROGRESSIVE EDUCATION PARTNERSHIP**

GENERAL CONTRACTOR:  
**MCN BUILD**

ASSOCIATE ARCHITECT:  
**R. MCGHEE & ASSOCIATES, PLLC**  
2031 Florida Ave. NW, 3rd Floor, DC 20009

CIVIL / SITE:  
**BRADLEY SITE DESIGN**  
1010 Wisconsin Ave. NW, Ste.620, DC 20007

LANDSCAPE:  
**BRADLEY SITE DESIGN**  
1010 Wisconsin Ave. NW, Ste.620, DC 20007

STRUCTURAL:  
**YUN ASSOCIATES**  
1050 Connecticut Ave. NW, Ste.500, DC 20036

MEPFP, LIGHTING & ENERGY MODELING:  
**CMTA INC. CONSULTING ENGINEERS**  
220 Lexington Green Circle Ste. 600, Lexington, KY 40502

FOOD SERVICE:  
**NYIKOS ASSOCIATES**  
7146 Starmount Way, New Market, MD 21774

**SPECIFICATIONS:**  
**HELLER & METZGER PC**  
 1899 Pennsylvania Ave. NW, Ste. 220, DC 20006

**SUSTAINABILITY, WELL, SPECIALIST:**  
**PERKINS EASTMAN ARCHITECTS**  
One Thomas Circle NW, Ste. 200, Washington, DC 20005  
ACQUISITION:

**POLYSONICS**  
405 Belle Air Lane, Warrenton, Va 20186  
AV, IT & SECURITY:

**CMTA INC. CONSULTING ENGINEERS**  
220 Lexington Green Cir. Ste. 600, Lexington, KY 40501  
CODE CONSULTANT:

ENVIRONMENTAL &amp; GEOTECHNICAL:

TRAFFIC CONSULT:  
**THE TRAFFIC GROUP**  
9900 Franklin Square Drive, Ste. H, Baltimore, MD 21114

PROJECT TITLE:

## TEMPLETON

TEMPLETON  
ELEMENTARY  
SCHOOL

BLADENSBURG, MD 20710

PROJECT No: 0100141

DRAWING TITLE:  
LAYOUT PLAN  
ENLARGEMENTS

SCALE: 1" = 20'

## L230

95% DESIGN DEVELOPMENT SET

01 NOVEMBER 2024

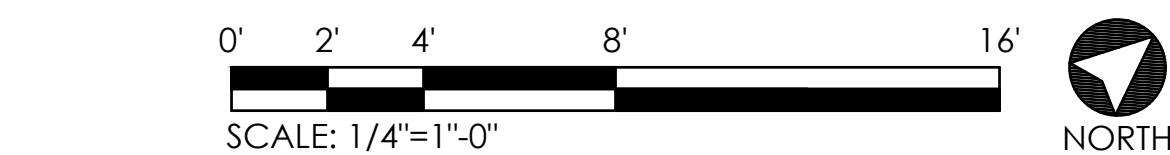
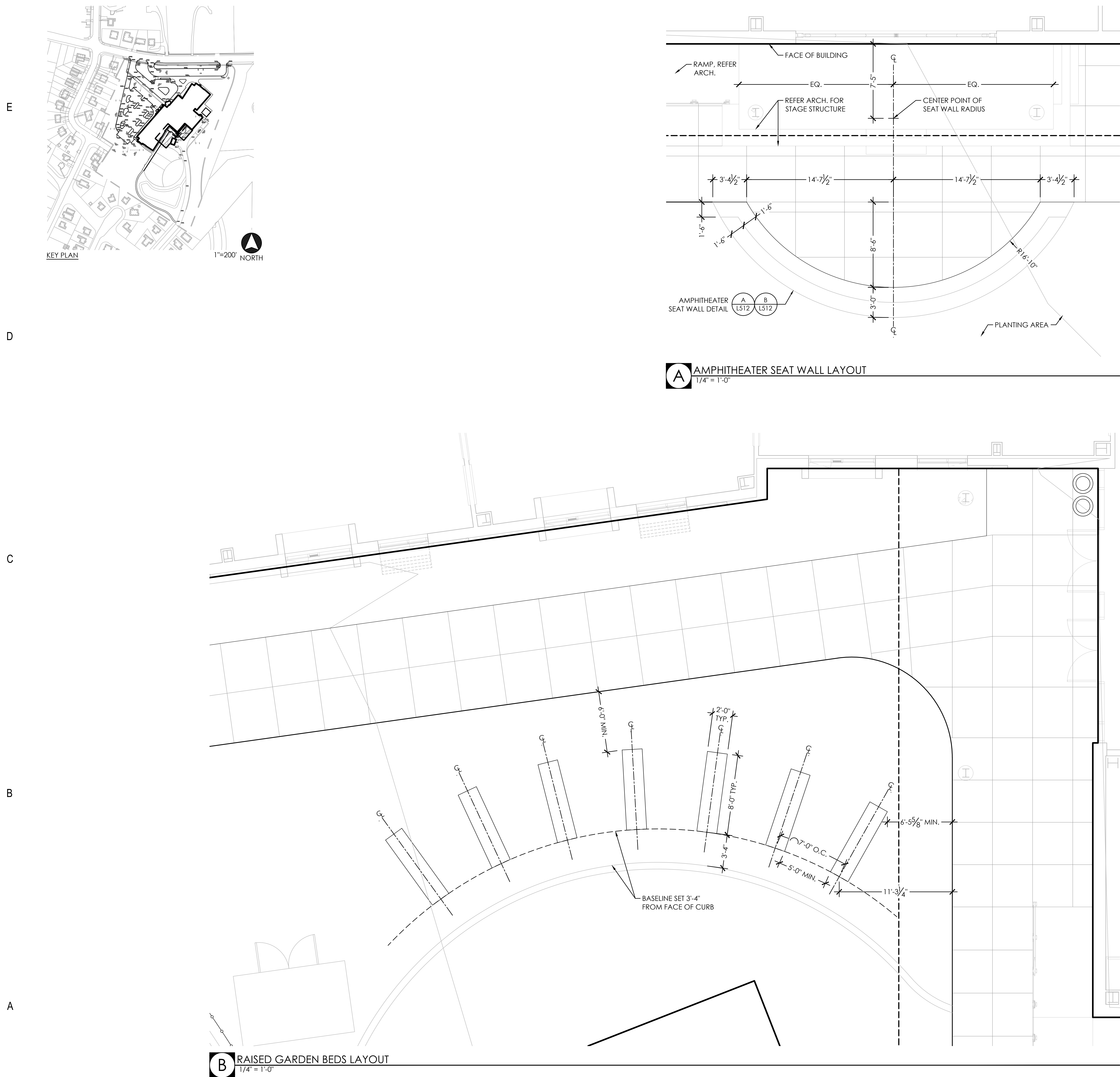

NOT FOR CONSTRUCTION





E  
  
D  
  
C  
  
B  
  
A

- SOILS LEGEND**
- TURF GRASS - 4" SOIL DEPTH  
PLANTING SOIL PREPARED PER SPECIFICATIONS  
SUBSOIL
  - PLANTING BED - 12" SOIL DEPTH  
PLANTING SOIL PREPARED PER SPECIFICATIONS  
SUBSOIL
  - RAISED GARDEN BED - 17" SOIL DEPTH  
EQUAL PARTS LEAFGRO®, VERMICULITE, AND PERLITE  
DRAINAGE GRAVEL SUBSOIL
  - TREE PLANTING - 30" SOIL DEPTH  
PLANTING SOIL PREPARED PER SPECIFICATIONS  
SUBSOIL
  - STORMWATER MANAGEMENT FACILITY, REFER CIVIL

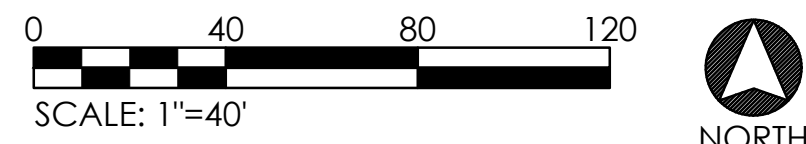

No.	Description	Date

PROJECT:  
**P3 PRINCE GEORGE'S COUNTY PUBLIC SCHOOLS BLUEPRINT SCHOOLS PH 2**

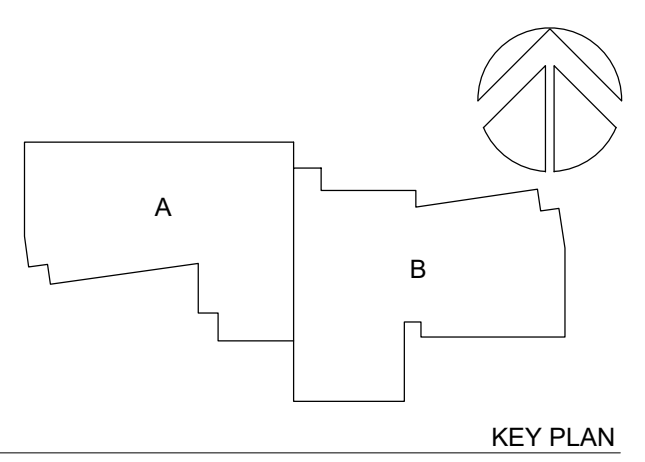

**PERKINS EASTMAN**  
One Thomas Circle NW, Suite 200  
Washington, DC 20005  
T: +1 202 861 1325  
F: +1 202 861 1328

OWNER:  
**PRINCE GEORGE'S COUNTY PUBLIC SCHOOLS**

CLIENT:  
**PROGRESSIVE EDUCATION PARTNERSHIP**

GENERAL CONTRACTOR:  
**MCN BUILD**  
1214 28TH ST NW, Washington, DC 20007

ASSOCIATE ARCHITECT:  
**R. MCGHEE & ASSOCIATES, PLLC**  
2031 Florida Ave. NW, 3rd Floor, DC 20009

CIVIL / SITE:  
**BRADLEY SITE DESIGN**  
1010 Wisconsin Ave. NW, Ste. 620, DC 20007

LANDSCAPE:  
**BRADLEY SITE DESIGN**  
1010 Wisconsin Ave. NW, Ste. 620, DC 20007

STRUCTURAL:  
**YUN ASSOCIATES**  
1050 Connecticut Ave. NW, Ste. 500, DC 20036

MEPPP, LIGHTING & ENERGY MODELING:  
**CMTA INC. CONSULTING ENGINEERS**  
220 Lexington Green Circle Ste. 600, Lexington, KY 40503

FOOD SERVICE:  
**NYIKOS ASSOCIATES**  
7146 Starmount Way, New Market, MD 21774

SPECIFICATIONS:  
**HELLER & METZGER PC**  
1859 Pennsylvania Ave. NW, Ste. 220, DC 20006

SUSTAINABILITY, WELL, SPECIALIST:  
**PERKINS EASTMAN ARCHITECTS**  
One Thomas Circle NW, Ste. 200, Washington, DC 20005

ACOUSTICS:  
**POLYSONICS**  
405 Belle Air Lane, Warrenton, Va 20186

AV, IT, & SECURITY:  
**CMTA INC. CONSULTING ENGINEERS**  
220 Lexington Green Cir. Ste. 600, Lexington, KY 40503

CODE CONSULTANT:

ENVIRONMENTAL & GEOTECHNICAL:

TRAFFIC CONSULT:  
**THE TRAFFIC GROUP**  
9900 Franklin Square Drive, Ste. H, Baltimore, MD 21236

PROJECT TITLE:

**TEMPLETON ELEMENTARY SCHOOL**

BLADENSBURG, MD 20710

PROJECT No: 0100141

DRAWING TITLE:  
**SOILS PLAN**

SCALE: 1"=40'

**L300**

95% DESIGN DEVELOPMENT SET

01 NOVEMBER 2024











[illegible]

PROJECT:  
**P3 PRINCE GEORGE'S COUNTY PUBLIC  
SCHOOLS BLUEPRINT SCHOOLS PH 2**

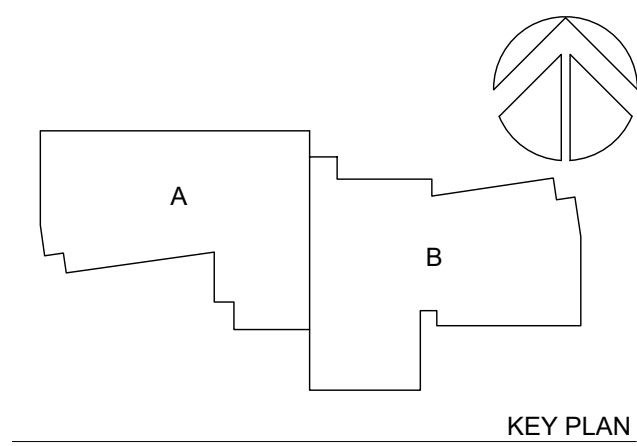

**PERKINS—  
EASTMAN**  
One Thomas Circle NW, Suite 200

OWNER:  
**PRINCE GEORGE'S COUNTY PUBLIC SCHOOLS**

CLIENT:  
**PROGRESSIVE EDUCATION PARTNERSHIP**

GENERAL CONTRACTOR:  
**MCN BUILD**  
1214 28TH ST NW, Washington, DC 20007

ASSOCIATE ARCHITECT:  
**R. MCGHEE & ASSOCIATES, PLLC**  
2031 Florida Ave. NW, 3rd Floor, DC 20009

CIVIL / SITE:  
**BRADLEY SITE DESIGN**  
1010 Wisconsin Ave. NW, Ste.620, DC 20007

LANDSCAPE:  
**BRADLEY SITE DESIGN**  
1010 Wisconsin Ave. NW, Ste.620, DC 20007

STRUCTURAL:  
**YUN ASSOCIATES**  
1050 Connecticut Ave. NW, Ste.500, DC 20036

MEPFP, LIGHTING & ENERGY MODELING:  
**CMTA INC. CONSULTING ENGINEERS**  
 220 Lexington Green Circle Ste. 600, Lexington, KY 40503  
 FOOD SERVICE:

**NYIKOS ASSOCIATES**  
7146 Starmount Way, New Market, MD 21774  
SPECIFICATIONS:

**HELLER & METZGER PC**  
1899 Pennsylvania Ave. NW, Ste. 220, DC 20006  
SUSTAINABILITY, WELL, SPECIALIST:

**PERKINS EASTMAN ARCHITECTS**  
One Thomas Circle NW, Ste. 200, Washington, DC 20005  
ACOUSTICS:

**POLYSONICS**  
405 Belle Air Lane, Warrenton, Va 20186  
AV, IT, & SECURITY:  
DATA MGMT. CONSULTING ENGINEERS

**CMTA INC. CONSULTING ENGINEERS**  
220 Lexington Green Cir. Ste. 600, Lexington, KY 40503  
CODE CONSULTANT:

ENVIRONMENTAL &amp; GEOTECHNICAL:

TRAFFIC CONSULT:  
**THE TRAFFIC GROUP**

9900 Franklin Square Drive, Ste. H, Baltimore, MD 21236

---

PROJECT TITLE:

TEMPLETON

ELEMENTARY  
SCHOOL

BLADENSBURG, MD 20710

BLADENSBURG, MD 20710

PROJECT No: 0100141

DRAWING TITLE:  
**PLANTING PLAN**

ENLARGEMENT -  
SOUTH

SCALE: 1" = 20'

## L 402

## L402

01 NOVEMBER 2024

